



15 Fern Avenue Bradbury, NSW

5 2 1

Five bedroom family home

An inviting and spacious family home nestled in the sought-after and prime enclave of Bradbury. Perched proudly on a 556sqm block, this well-appointed home spans over two levels ? with carport, and under-house storage located on the lower level. Within a short drive to Macarthur Square, train stations, public and private hospitals, schools and Western Sydney University.

- Five bedrooms, three lower level bedrooms with two upper level bedrooms
- Upper level master bedroom with ensuite and access to bedroom two and study
- An expansive open plan living area flowing seamlessly to outdoor alfresco area
- Centrally located modern kitchen with cathedral ceiling and premium stainless steel appliances

For more details please visit <https://www.gyproperty.com.au/8114592>



Anna Younan

0416 053 838

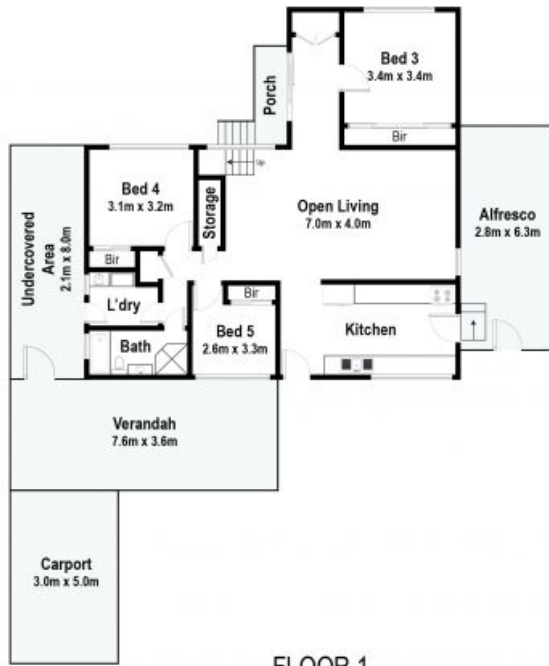

FLOOR 1

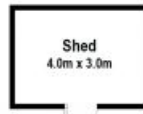

(Not in Place)



FLOOR 2

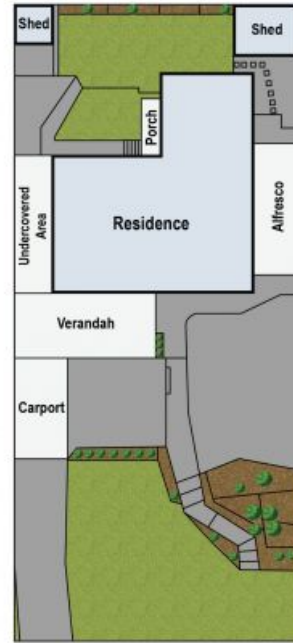

SITE PLAN



0 1 2 3 4 5 SCALE (METERS)

Scale in meters. Indicative only. All information contained herein is obtained from sources we believe to be accurate. We cannot guarantee its accuracy. Interested persons should make and rely on their own enquiries.

15 Fern Avenue, Bradbury

