



457 Thirlmere Way Thirlmere, NSW

7 4 19

## Main Dwelling and Granny Flat on 1.27 Acres

Located in the beautiful suburb of Thirlmere in the Wollondilly shire, this unique semi-rural property is set on a beautifully landscaped 1.27 acres surrounded by trees and fauna. The natural light from the windows flows in and creates a dramatic design feature that highlights the timber ceiling which gives the home an airy open spacious feel. With two street frontages, this home is within an hour from Sydney and keeping the peace and country charm. Just minutes drive to Tahmoor and Picton.

- Main dwelling featuring five bedrooms, three bathrooms, ensuite to master and guest room
- Two living areas with grand cathedral style ceilings with exposed beams, sky lights and feature glass windows,
- Wood fireplace to the living area, separate study /office area with built in desk
- The granny flat is currently rented to long term tenants at \$300/week
- An expansive 25 x 9.8m machinery shed/workshop with loading bay, three phase power, town water and set up for car enthusiasts with a

For more details please visit <https://www.gyproperty.com.au/6924907>

[www.gyproperty.com.au](http://www.gyproperty.com.au)

PH: 02 4648 4058 | FAX: 02 4648 4059

1/125 Argyle Street, Camden, NSW 2570

**Gilbert + Younan Sales**

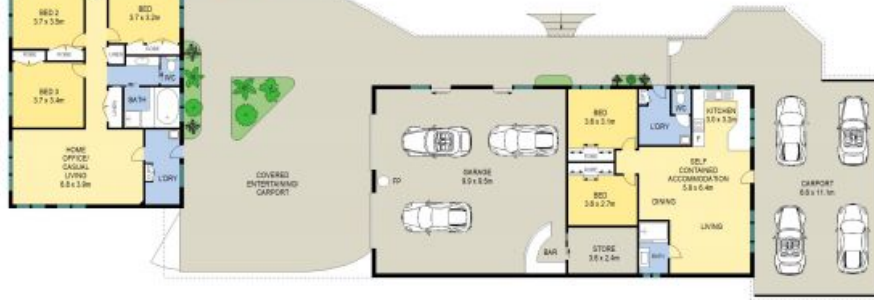

Scale in metres. Indicative only. All information contained herein is obtained from sources we believe to be accurate, we cannot guarantee its accuracy. Interested persons should make and rely on their own enquiries.

457 Thirlmere Way, Thirlmere



457 Thirlmere Way, Thirlmere, NSW

