



5 Ballantrae Drive St Andrews, NSW



Generously proportioned family home

Generously proportioned, this much-loved family home offers outstanding lifestyle options with multiple formal and casual rooms. Nestled on 590sqm parcel in a convenient location within walking distance to shops, schools, and transport.

- Three spacious bedrooms all with built-in robes
- Galley style kitchen with dishwasher and breakfast bar
- A selection of formal and casual living areas
- Tastefully updated bathroom, neutral colour tones
- Ducted air conditioning for year round comfort
- Covered entertaining terrace overlooking rear garden
- Double garage with drive through access to one
- Fully fenced, low maintenance rear yard, garden shed
- Located close to schools, shops and public transport
- An ideal opportunity for investment or owner occupier

For more details please visit <https://www.gyproperty.com.au/5367563>



Luke Mannion

0428 473 629



Luke Mannion

0428 473 629

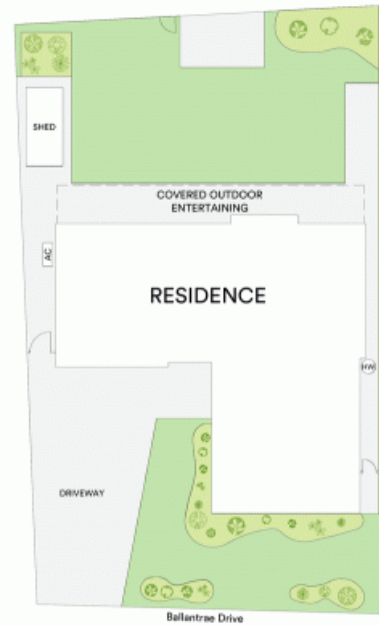
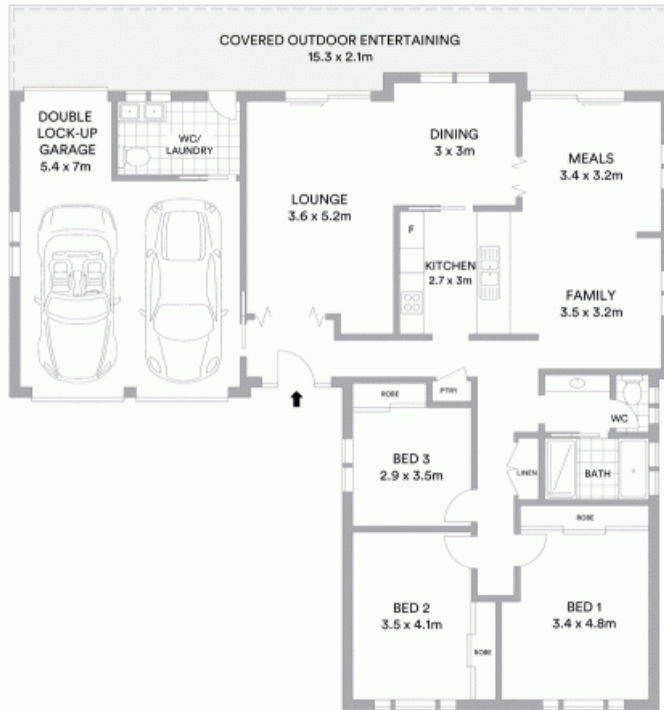

McGrath

Scale in metres. Indicative only. All information contained herein is obtained from sources we believe to be accurate. We cannot guarantee its accuracy. Interested persons should make and rely on their own enquiries

