



26 Parkhill Avenue Leumeah, NSW

4 2 2

Abundance of space to appease growing families

Tucked away amongst beautiful manicured gardens, this charming home has been constructed to appease growing families. A balance of both living and entertainment, all while being generously set on a 560sqm parcel of land.

- Beautiful facade with impeccable street appeal
- Three spacious bedrooms including master retreat
- Two generous bathrooms with an ensuite to the master
- Grand family lounge room with vaulted timber ceilings
- Superb designated living and dining areas
- Oversized downstairs rumpus equipped with built-in bar
- Built-in study nook, self contained storage under the home
- Covered outdoor deck with district views
- Double remote garage with internal access
- Moments to shopping, schools, parks and transport

For more details please visit <https://www.gyproperty.com.au/5364249>



Luke Mannion

0428 473 629



Anna Younan

0416 053 838

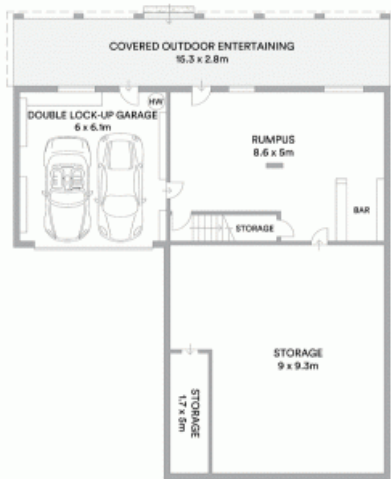

GROUND LEVEL



ENTRY LEVEL



McGrath

Scale in metres. Indicative only. All information contained herein is obtained from sources we believe to be accurate. We cannot guarantee its accuracy. Interested persons should make and rely on their own enquiries

